

Schematic diagram of connecting devices

Installation and connection

Phantom 48V power supply mode.

Connect mixers, power boxes and other audio peripheral products with phantom 48V power supply.

Mixer



User Manual

Wired Conference Microphone



Factory address:

Jagtvej 153,203
2200 Copenhagen, Denmark

UK Sales Office address:

128 City Road, London, United Kingdom, EC1V 2NX
+44 2039088010

www.nordlyslight.com

Thank you for purchasing our wired conference microphone product.

Please read the instructions carefully before use.

Product Introduction

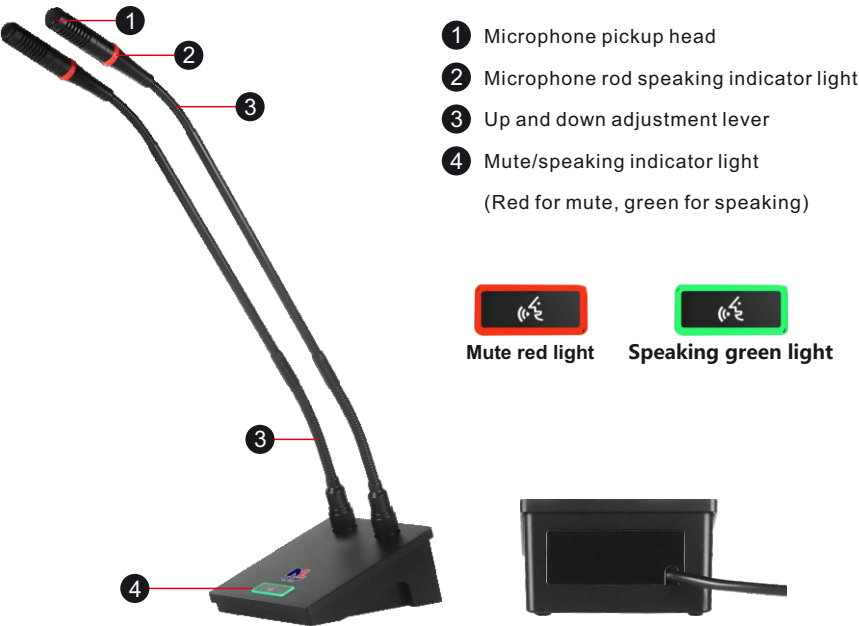

Technical parameters

Transducer mode	Capacitive
Directional	Cardioid
Sensitivity	-32dB±2dB
Effective pickup distance	20-60cm
Switch	Electronic touch
Frequency response (Hz)	40Hz-16KHz
Output impedance (ohm)	200Ω
Supply voltage (V)	Phantom 48V
Audio cable	6m dual-core XLR male
Base specifications	164*113*60mm (width*depth*height)

Product Comprehensive Description

Functional features

- The product is well-made and has a rich texture, perfect arc shape, and is exquisite and decent.
- It has a flat and wide frequency response and excellent directional characteristics, high sensitivity and strong ability to withstand sound pressure.
- Phantom 48V power supply, wide range of adaptability.
- The light-touch electronic switch and the short-bar square light ring have dual indications of working status, which are bright and eye-catching.
- Specially set up a two-color luminous mute/speak button indicator light.
- It is suitable for news releases and strict mid-to-high-level meeting places, and is deeply loved by users in engineering bidding.

Operation (testing the connection between microphone and audio equipment)

- (1) Connect the microphone to the mixer or other equipment with 48V phantom power output using the built-in audio cable, and turn on the 48V power supply.
- (2) First, make sure that the volume knob of power amplifier or mixer is turned to the minimum or has been returned to "0". Select the placement of the microphone, then press the microphone switch and the power amplifier or mixer switch, turn on the microphone, the indicator light and the indicator ring light up, then speak to the microphone pickup head, and slowly adjust the volume of the power amplifier or mixer until the volume reaches the optimal effect without howling.

Notes

- (1) Do not put the microphone's pickup head towards the speaker to avoid howling.
- (2) Do not turn up the volume too high to avoid howling.